

Art of Smooth Performance

VTURN S26

Strong
and
Steady
Turning
Center

- *Servo turret*
- *One-piece slant bed*
- *Box slideways*
- *High thrust force*
- *High Rapid feeds*
- *Rotary operation panel*



Smooth & Steady Performance

Vturn-S26 Turning center

- One piece 30° slant bed
- Large swing diameter 600 mm
- 10" power chuck
- Z-axis travel 610 mm
- High thrust force 1441 kgf
- High rapid feed 18/24 m/min (X/Z)
- Machine weight 6130 kg
- C-axis available



Spindle 22kW (S3-25%)

- Spindle output 574 Nm (S3-25%)
- Low base speed 307 rpm only
- NN type (roller type) bearings
- Shortened belt length
- Victor Taichung's own spindle

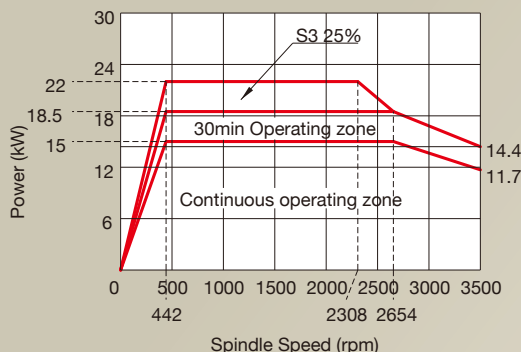
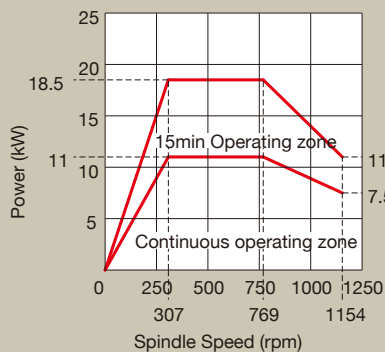
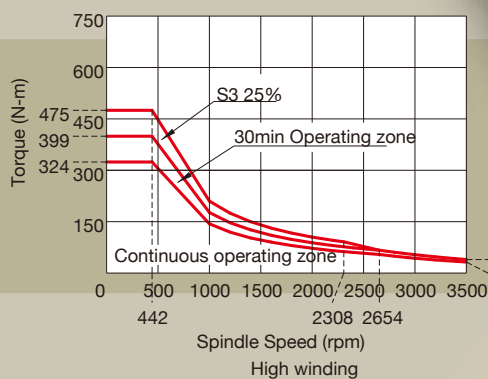
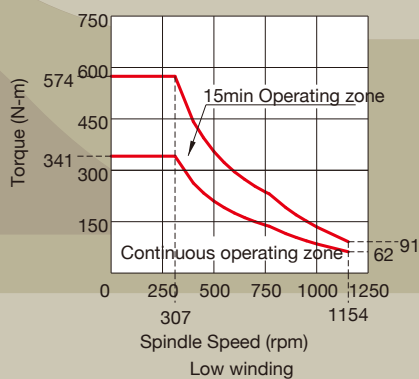

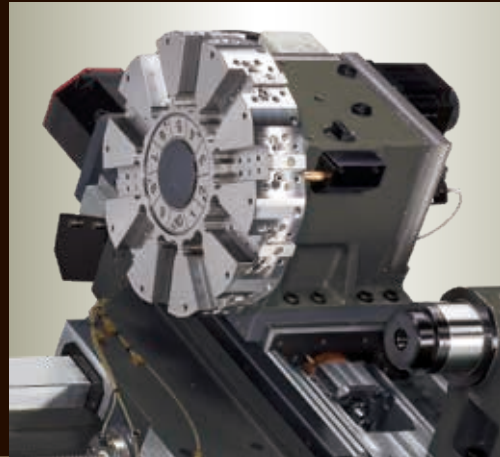
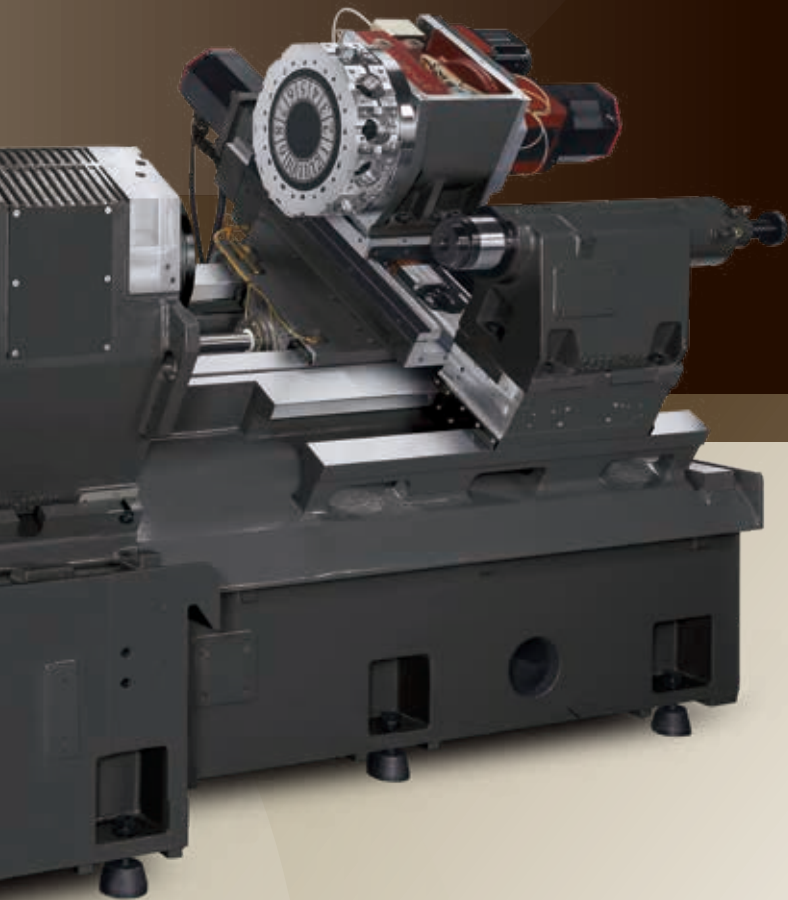

Servo Turret 0.8 sec. (adjacent tools)

- Turret indexing time 0.8 sec (adj.), 1.0 (opposite)
- High thrust (Z-axis) 1441 kgf (14.1 kN)
- Milling turret BMT-65 (3-piece coupling)
- 12 stations live tools
- Milling power 4.5kW/4000rpm (opt. 6000rpm)
- Victor Taichung's own turret

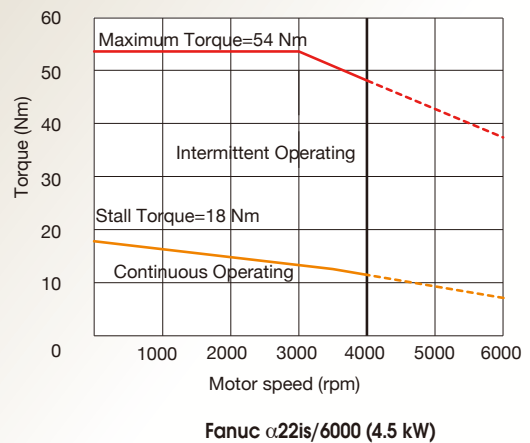

Certificated Casting

GM400

GA350

Boxways 64/80 mm (X/Z)

- High rapid feeds 18/24 m/min
- Smooth operation guaranteed
- Victor Taichung's own casting

Tailstock MT-5

- Twin cylinder clamping
- Tow along by turret
- Opt. MT-4 with built-in bearings

Standard and Options

- Fanuc Oi-TF (type-1) control with 8.4" screen
- Programmable tailstock (MT-5)
- Rotary operation panel
- Door moving along LM guideways
- Coolant flush onto Z-axis covers
- Built-in LED light
- Chip conveyor



Conveyor motor cover (opt.)



Chip conveyor (std.)

Coolant flush (std.)



Tool presetter (opt.)



Tooling accessories (excl. BMT turret model)

TOOLS \ MODEL	Vturn-S26
Tool shank for turret disk	25 mm (1")
Maximum boring bar dia.	50 mm (2")
Face + OD cutting tool holder	1
Face + ID. cutting tool holder	1
Boring bar holder	
40 mm (1 1/2")	7
50 mm (2")	-
Boring bar sleeve	
8 mm (5/16")	1
10 mm (3/8")	2
12 mm (1/2")	2
16mm (5/6")	2
20 mm (3/4")	2
25 mm (1")	2
32 mm (1 1/4")	2
Drill socket	
MT1	Opt.
MT2	1
MT3	1
MT4	1
U drill socket	
20 mm	Opt.
25 mm (1")	1
32 mm (1 1/14")	1

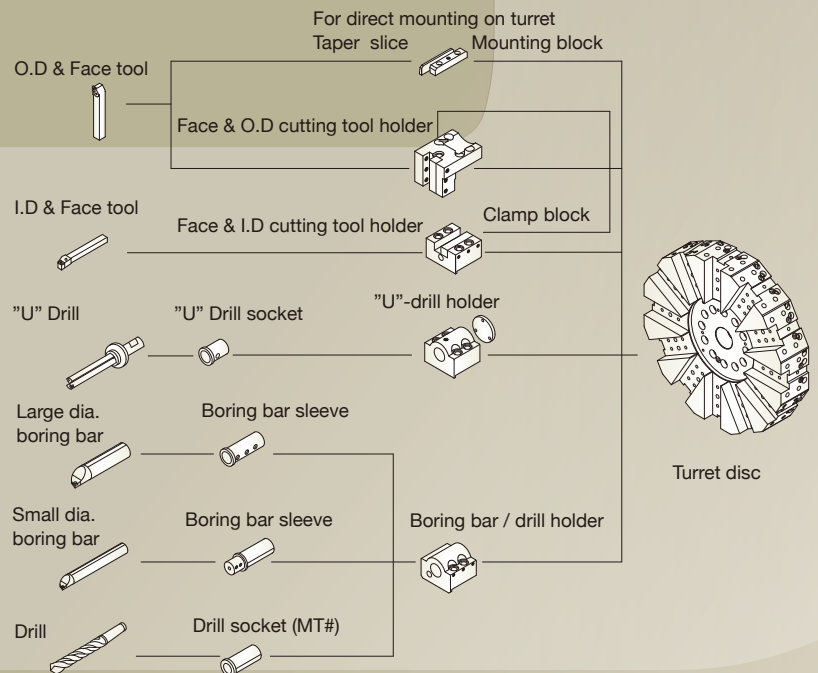



Transformer, A/C for cabinet (opt.)



10.4" / 15" screen with Manual Guide I (opt.)

Part catcher (opt.)



Oil skimmer (opt.)

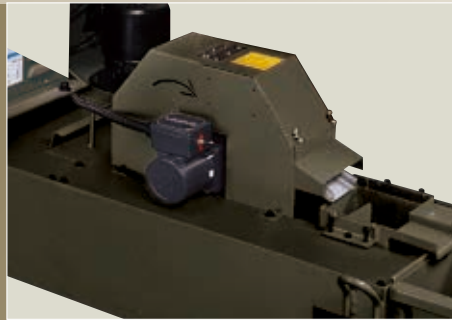

BMT-65 turret (opt.)

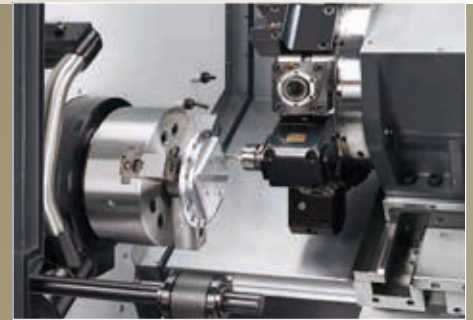

C-axis Application

Vturn-S26CM with BMT-65 Milling Turret (Optional)

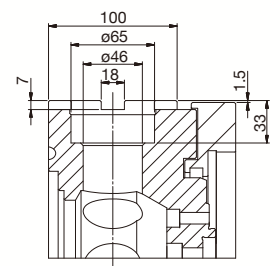
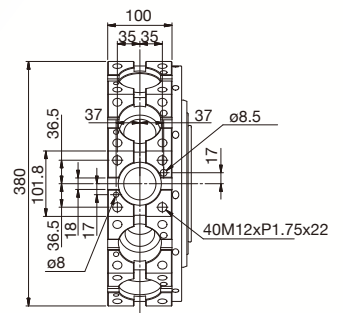
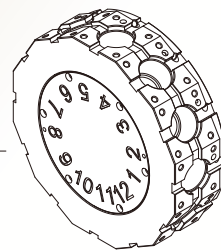
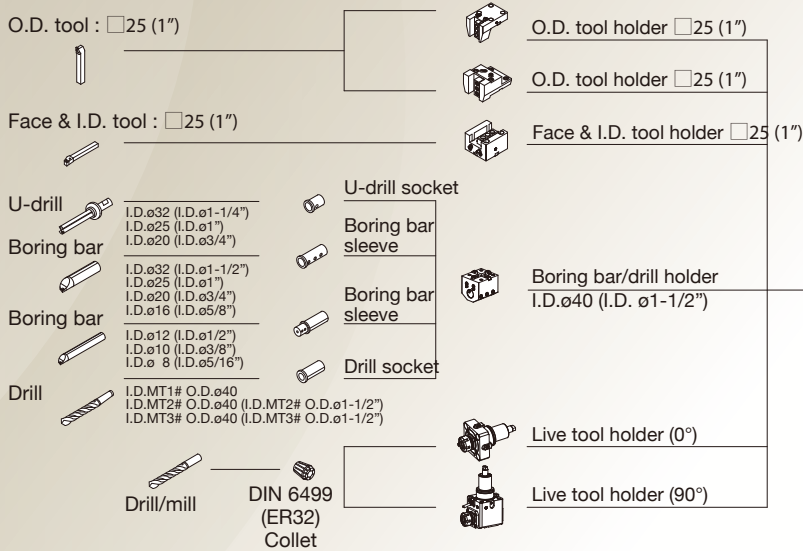

VICTOR Taichung's FANUC Oi-TF 8.4" Control (Type I) Specifications

Standard

ITEM/SPECIFICATION

DESCRIPTION

Controlled Axes:

1. Controlled axes	2 Axes (X, Z)
2. Simultaneous controlled axes	2 Axes
3. Least input increment	0.001mm
4. Least command increment	0.0005mm (X) / 0.001mm (Z)
5. Command system	Incremental / Absolute
6. HRV Control	HRV3+
7. Unexpected disturbance torque detection (AIR-BAG)	Std.
8. Backlash compensation	Std.
9. Stored pitch error compensation	Std.

Operation & Program Input:

1. Input / Output interface	RS-232, PCMCIA Card, USB
2. Tool offset	99 sets
3. Sequence number	N5-Digit
4. Program number	O8-Digit
5. Program name	31-characters
6. M code function	M3-digit
7. S code function	S4-digit
8. T code function	T4-digit
9. Positioning	G00
10. Linear interpolation	G01
11. Circular interpolation	G02, G03
12. Programmable data input	G10
13. Plane selection	G17-G19
14. Inch / Metric conversion	G20 / G21
15. Reference position return	G28, G30
16. Thread cutting	G32, G34
17. Threading retract	Std.
18. Tool nose radius compensation	G40-G42
19. Work piece coordinate system	G52-G59
20. Macro, Sub program call	G65, M98, M99 (10 folds nested)
21. Multiple repetitive cycle I & II	G70-G76
22. Canned cycle for drilling	G80-G89
23. Canned cycles	G90, G92, G94
24. Program stop / end	M00-M02 / M30
25. Rigid tapping (Spindle)	M29
26. Dynamic graphic display (for 8.4")	Std.
27. Manual Guide Oi (for 8.4")	Std.
28. Manual Guide I (for 10.4/15")	Opt.
29. Optional blocks skip 2-9	Std.

Feed Function:

1. Manual handle feed rate	X1, X10, X100
2. Rapid traverse rate	F0, 25%, 50%, 100%
3. Cutting feed rate	0-150%
4. Spindle override	50-120%
5. Feed per Minute / Revolution	G98 / G99

Edit Operation:

1. Part Program Storage Length (in total)	1280m / 512kB (Oi / 32iB)
2. Number of Registerable programs (in total)	400
3. Part Program Editing	Std.

C Axis Function:

1. Polar coordinate interpolation	Std. (G112/G113)
2. Cylindrical interpolation	Std. (G107)
3. CS contouring control	Std.
4. Spindle control with servo motor	G96.4
5. Coordinate System Rotation	Std.

OPTIONS

With hardware included

1. Tool life management	<input type="checkbox"/>
2. Program restart	<input type="checkbox"/>
3. Data server (with PCB and ATA card)	<input type="checkbox"/>
4. Fast Ethernet (100Mbps, available in Data server)	<input type="checkbox"/>
5. CC Link (required for robot)	<input type="checkbox"/>
6. PROFIBUS slave	<input type="checkbox"/>

Without hardware included

7. Part program storage length (5120m/2MB)	<input type="checkbox"/>
8. Number of registerable programs 1000	<input type="checkbox"/>
9. Circular thread cutting (G35,G36)	<input type="checkbox"/>
10. AICC-1 (G5.1 Q1, 40 blocks)	<input type="checkbox"/>
11. AICC-2 (G5.1 Q1, 200 blocks)	<input type="checkbox"/>
12. Helical interpolation (C-axis only)	<input type="checkbox"/>
13. Arbitrary speed threading	<input type="checkbox"/>

Optional Spindle Output (18.5/22/26 KW, S3-25%)

Machine Color Option

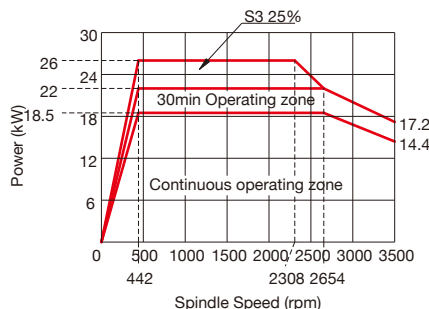
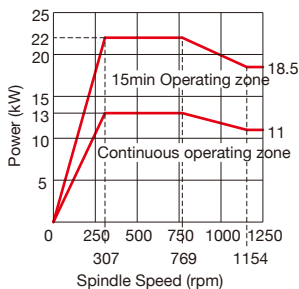
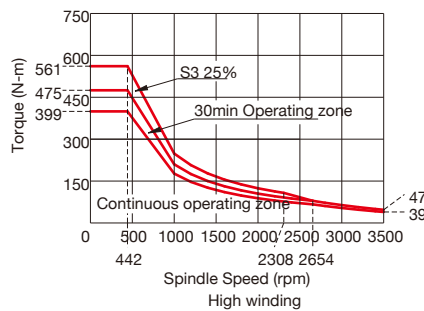
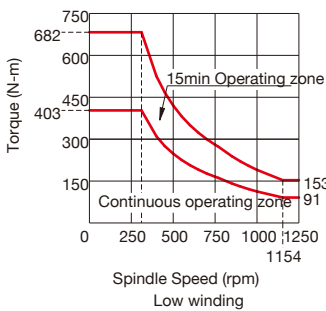

Standard



RAL-7024

Interference Chart / Operating Range



Vturn-S26

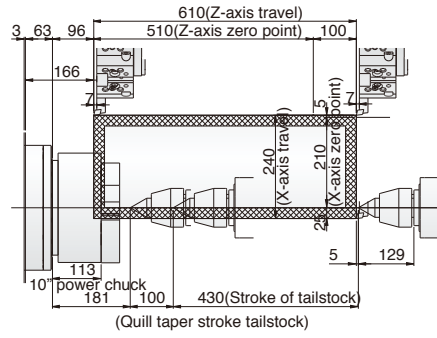
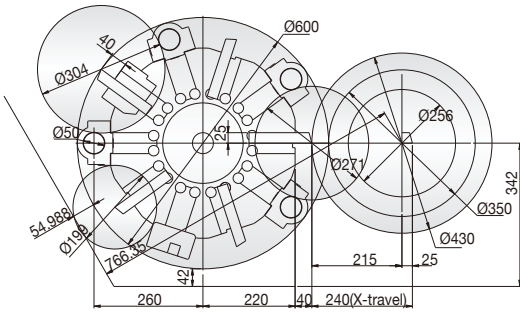

Vturn-S26CM

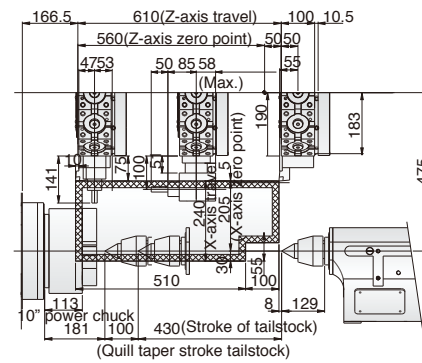
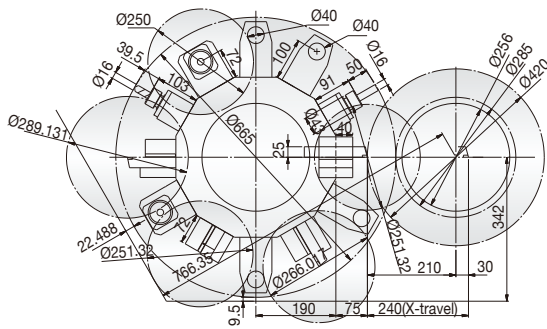

Machine Layout

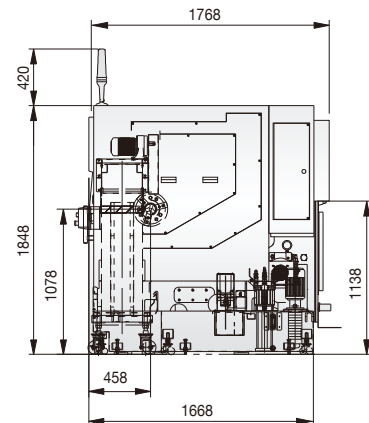
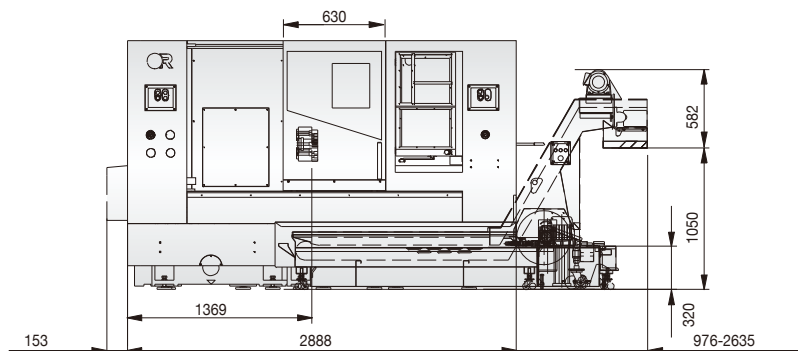
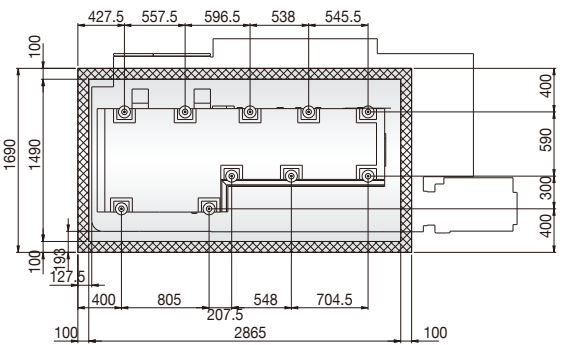
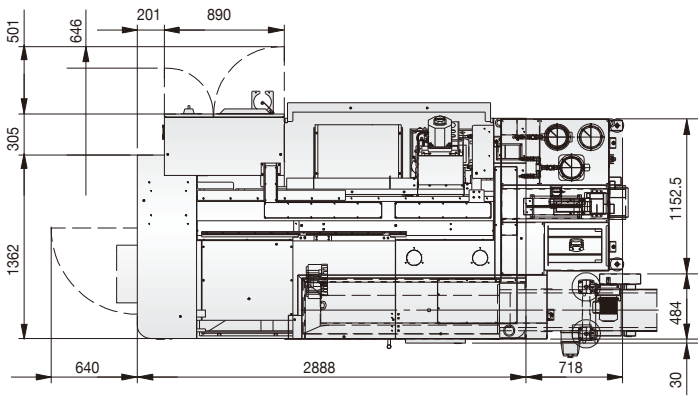

Machine Specification

Item	Unit	Vturn-S26 (CM)	
CAPACITY	Swing over bed dia.	mm	ø600
	Standard turning dia.	mm	ø350 (ø285)
	Maximum turning dia.	mm	ø430 (ø420)
	Swing over carriage dia.	mm	ø480
	Between centers	mm	550
Bar capacity (Hole thru draw bar)	mm	ø75 (opt. 77)	
AXIS FEEDS	X axis travel	mm	215+25 (210+30)
	Z axis travel	mm	610
	Rapid feed - X / Z axis	m/min	18 / 24
	Feed motor - X / Z axis	kW	4 / 4
	JOG feed	m/min	X/Z: 0~1260
	Ball screw dia x pitch	mm	ø32×P6 (X), ø40×P8 (Z)
SPINDLE	Spindle speed	rpm	3500 (opt. 2500)
	Spindle nose (chuck)	inch	A2-8 (10")
	Spindle motor power (cont./30min/25%)	kW	15 / 18.5 / 22 (opt. 18.5 / 22 / 26)
	Spindle bearing inside dia.	mm	ø130
	Spindle taper		1/20
TURRET	No. of tools (live)		10 (12) servo
	Tool shank size	mm	□25
	Max. boring bar dia.	mm	ø50 (BMT-65)
	Exchange time (T-T)	sec	0.8 (0.81) - adjacent 1.0 (1.25) - opposite
	Milling speed	rpm	4000 (opt. 6000)
	Milling motor	kW	4.5
TAILSTOCK	Tailstock quill dia.	mm	ø110
	Quill stroke	mm	100
	Quill taper		MT #5 (opt. MT#4)
CAPACITY	NC controller	Fanuc	0i-TF (8.4")
	Coolant tank capacity	L	330
	Power requirement	kVA	27 (29)
	Machine dimension LxWxH (with chip conveyor)	mm	4017 x 1848 x 1819
	Net weight	kgs	6130 (6230)

Standard Accessories:

- Fanuc 0i-TF(8.4") with Manual Guide 0i
- Hydraulic chuck with soft jaws
- Programmable tailstock
- Chip conveyor
- Fully enclosed splash guarding
- Hand wheel
- Tool holders (for standard turret only)
- Coolant flush on Z-axis cover
- 3 step warning light

Optional Accessories:

- Fanuc 0i-TF(10.4") with Manual Guide I (MGI)
- Manual tool presetter
- Auto tool presetter
- Parts catcher (swing type)
- KITAGAWA® power chuck
- Air conditioner for electrical cabinet (Panel cooler)
- 12" chuck (3000 rpm spindle)
- Higher pressure coolants
- Bar feeder interface
- Air blow
- Oil skimmer
- Oil mist collector
- Auto door
- Hard jaws
- Tailstock center
- Transformer
- C-axis (Vturn-S26CM)

* Machine and controller specifications are subject to change without notice.

Victor Taichung profile:
 Sales turnover: USD 145 mil's (in 2017)*
 No. of employees: 859
 *Exchange rate: 1 USD=30 TWD.



TAIWAN
<http://www.victortaichung.com>
 E-mail :info@mail.or.com.tw
 Victor Taichung Machinery Works Co., Ltd.
Headquarters:
 2088, Sec. 4, Taiwan Blvd.,
 Taichung, Taiwan, R.O.C.
 TEL : 886-4-23592101
 FAX : 886-4-23592943
Overseas Marketing Division:
 TEL : 886-4-23580701
 FAX : 886-4-23584541

UK
 Victor CNC (UK) Ltd.
 TEL : 44-1-706-648485
 FAX : 44-1-706-648483

FRANCE
 Victor France
 TEL : 33-1-64772000
 FAX : 33-1-64772063

GERMANY
 Victor GmbH
 TEL : 49-2261-478434
 FAX : 49-2261-478327

MALAYSIA
 Victor Machinery (M) SDN. BHD.
 TEL : 60-3-56337180
 FAX : 60-3-56337191

THAILAND
 Victor (Thailand) Co. Ltd.
 TEL : 66-2-9263735
 FAX : 66-2-9032373

INDONESIA
 PT. Victor Machinery Indonesia
 TEL : +62-21-88958504
 FAX : +62-21-88958513

USA
 Fortune International Inc.
 TEL : 1-732-2140700
 FAX : 1-732-2140701

SOUTH AFRICA
 Victor Fortune (PTY) Ltd.
 TEL : 27-11-3923800
 FAX : 27-11-3923899

CHINA
 Victor Taichung Machinery (Shanghai)
 TEL : 86-21-59768018
 FAX : 86-21-59768008